

PRTB10 塑料滚动推力轴承 Plastic ball thrust bearings



PRTB10作为通用性更强的塑料滚动轴承材料具有良好的强度和耐磨性，由于其材料自身的润滑性噪音较低；此类轴承碱性环境下表现良好但不适合在酸性环境下长期运行。标准配置内外圈材料为：改良POM，滚珠材料为：玻璃球或不锈钢（选配）；长期连续使用温度-40 ~ +80°C。

PRTB10 has good strength and wear resistance as a generic plastic ball bearings, the operation noise very low because the self-lubrication of the material; These bearings perform well in an alkaline environment but not for long-term operation in an acidic environment. The standard material of inner and outer ring: POM, ball material: glass or stainless steel; The long-term operation temperature: -40 ~ +80°C.

标准规格 Standard specifications

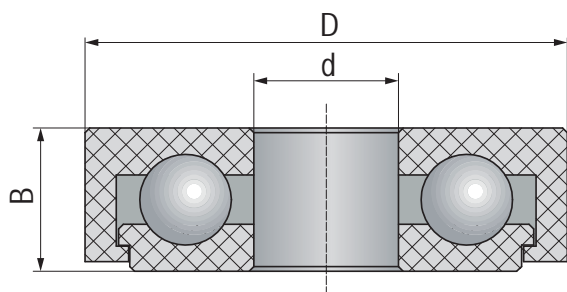

产品编码 Part No.:

PRTB10-51100-GL

GL: 玻璃球 Glass balls

ES: 不锈钢球 Stainless steel balls

轴承规格 Specification

型号 Type

产品编码 Part No.	产品编码 Part No.	d [mm]	D [mm]	B [mm]	极限静载荷 Max. static load [N]	极限动载荷 Max. dynamic load [N]	极限转速 Max. speed [RPM]	重量 Weight [g]	
								-GL	-ES
PRTB10-51100-GL	PRTB10-51100-ES	10	24	9	200	250	600	4.0	5.2
PRTB10-51200-GL	PRTB10-51200-ES	10	26	11	210	260	600	6.1	7.9
PRTB10-51101-GL	PRTB10-51101-ES	12	26	9	320	400	540	4.4	5.6
PRTB10-51201-GL	PRTB10-51201-ES	12	28	11	330	410	540	7.2	9.5
PRTB10-51102-GL	PRTB10-51102-ES	15	28	9	500	625	500	4.7	6.1
PRTB10-51202-GL	PRTB10-51202-ES	15	32	12	520	650	500	9.3	11.5
PRTB10-51103-GL	PRTB10-51103-ES	17	30	9	570	710	480	5.2	6.8
PRTB10-51203-GL	PRTB10-51203-ES	17	35	12	600	750	480	10.7	14.9
PRTB10-51104-GL	PRTB10-51104-ES	20	35	10	650	810	460	7.6	10.3
PRTB10-51204-GL	PRTB10-51204-ES	20	40	14	690	860	460	15.7	20.5
PRTB10-51105-GL	PRTB10-51105-ES	25	42	11	710	880	410	11.3	14.6
PRTB10-51205-GL	PRTB10-51205-ES	25	47	15	750	930	400	22.2	26.5
PRTB10-51106-GL	PRTB10-51106-ES	30	47	11	760	950	400	13.4	17.3
PRTB10-51206-GL	PRTB10-51206-ES	30	52	16	820	1025	375	26.9	34
PRTB10-51107-GL	PRTB10-51107-ES	35	52	12	810	1010	390	16.6	20.8
PRTB10-51207-GL	PRTB10-51207-ES	35	62	18	870	1090	365	44.3	56.9
PRTB10-51108-GL	PRTB10-51108-ES	40	60	13	890	1110	375	24.7	31.2
PRTB10-51208-GL	PRTB10-51208-ES	40	68	19	940	1175	350	53.1	67.1
PRTB10-51109-GL	PRTB10-51109-ES	45	65	14	950	1185	360	28.2	37.5
PRTB10-51209-GL	PRTB10-51209-ES	45	73	20	1010	1260	330	62.1	86.7
PRTB10-51110-GL	PRTB10-51110-ES	50	70	14	1020	1275	340	30.5	40.5
PRTB10-51210-GL	PRTB10-51210-ES	50	78	22	1100	1375	310	80.4	107